

The Long Bay[®] System

Architectural Guide



WHY CHOOSE THE

Long Bay® System over Traditional Bar Joists?

Supporting the Building Owner

- **Aesthetically Pleasing:** The Long Bay® System reduces the number of interior columns providing larger, unobstructed areas for maximum usage of floor space
- **Faster Occupancy:** With single-source control and planning of your construction schedule, the Long Bay® System promises a predictable delivery and ease of erection
- **Lowens Costs:** Due to reduced foundation costs and easier erection, the Long Bay® System lowers overall in-place construction costs compared to other pre-engineered building systems
- **Quality:** The Long Bay® System provides quality assurance and the expected performance from an IAS certified manufacturer

Testing & Quality Assurance

- Produced in IAS certified facilities
- Statistical sampling of all Long Bay® System joists tested for specified design loads
- Tested with thru-fastened and Standing Seam Roof Applications
- Factory Mutual (FM) ratings are available per your specific requirements

Architects are saying...

"The bridging runs of the Long Bay® System are straight so the interior look is clean."

"Integration with roofing systems made project coordination issues less likely."

"One source for specifying system eliminates the use of multiple sections and cross references decreasing the potential for error and omission conflicts."

"The Long Bay® System is a great alternative system that helps meet budget needs."

"Due to more expedient erection times, the building owner is able to move in sooner than with the traditional bar joists allowing them to start production sooner."





WHAT IS THE Long Bay® System Advantage?

Over the past 12 years, Mesco Building Solutions has covered over 56 million square feet with the Long Bay® System, a unique solution that replaces conventional bar joists for a more designer-friendly and aesthetically-pleasing roofing system. Offering exceptional strength-to-weight ratios, the Long Bay® System is machine rolled for accuracy and allows for tighter tolerances. Additionally, this product is stiffer and lighter than bar joists with less sweep and warp. It offers greater design flexibility since it can be used with hard wall and metal cladding applications. While welded connections are optional, the Long Bay® System uses bolted connections versus the bolt and welding of traditional bar joists.

The Basics

- While 50' bays are typical, the Long Bay® System has the capabilities of spanning over 65'
 - Roof loading above 70 psf
 - Ideally suited for machine-seamed Standing Seam, Built-Up, Single-Ply, and Multi-Ply roofing systems
 - Reinforced die-formed
 - A patented IAS certified product
- 

A

Long Bay® Purlin with Double-Lok® Rake Condition (On Module)

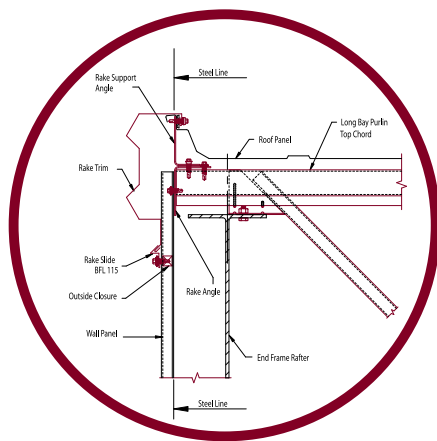

B

Flange Brace Connection

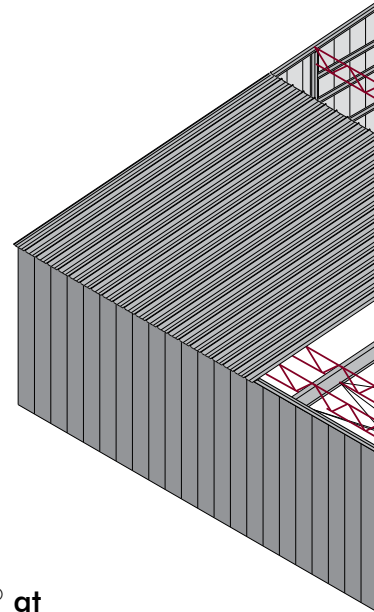
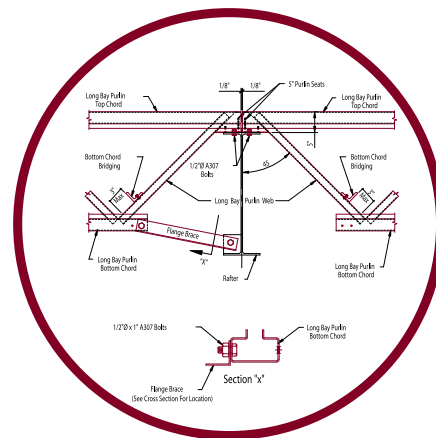

C

Long Bay® Connection at Low Side Soldier Column

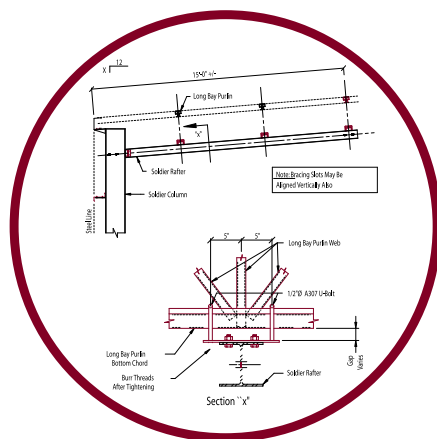

D

Long Bay® Purlin with Double-Lok® Ending Rake Condition (On Module)

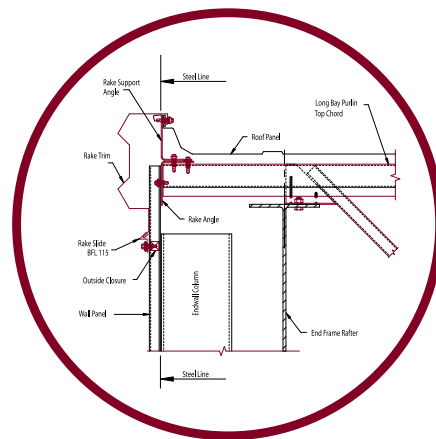

E

Long Bay® at Masonry Parapet

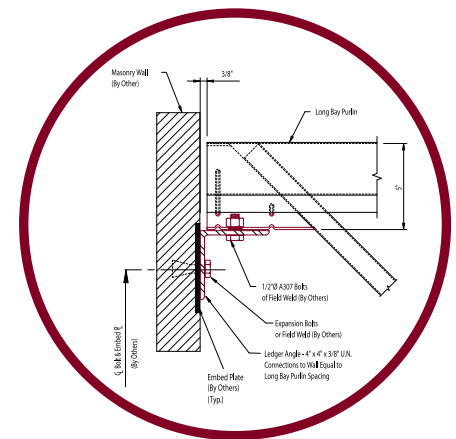

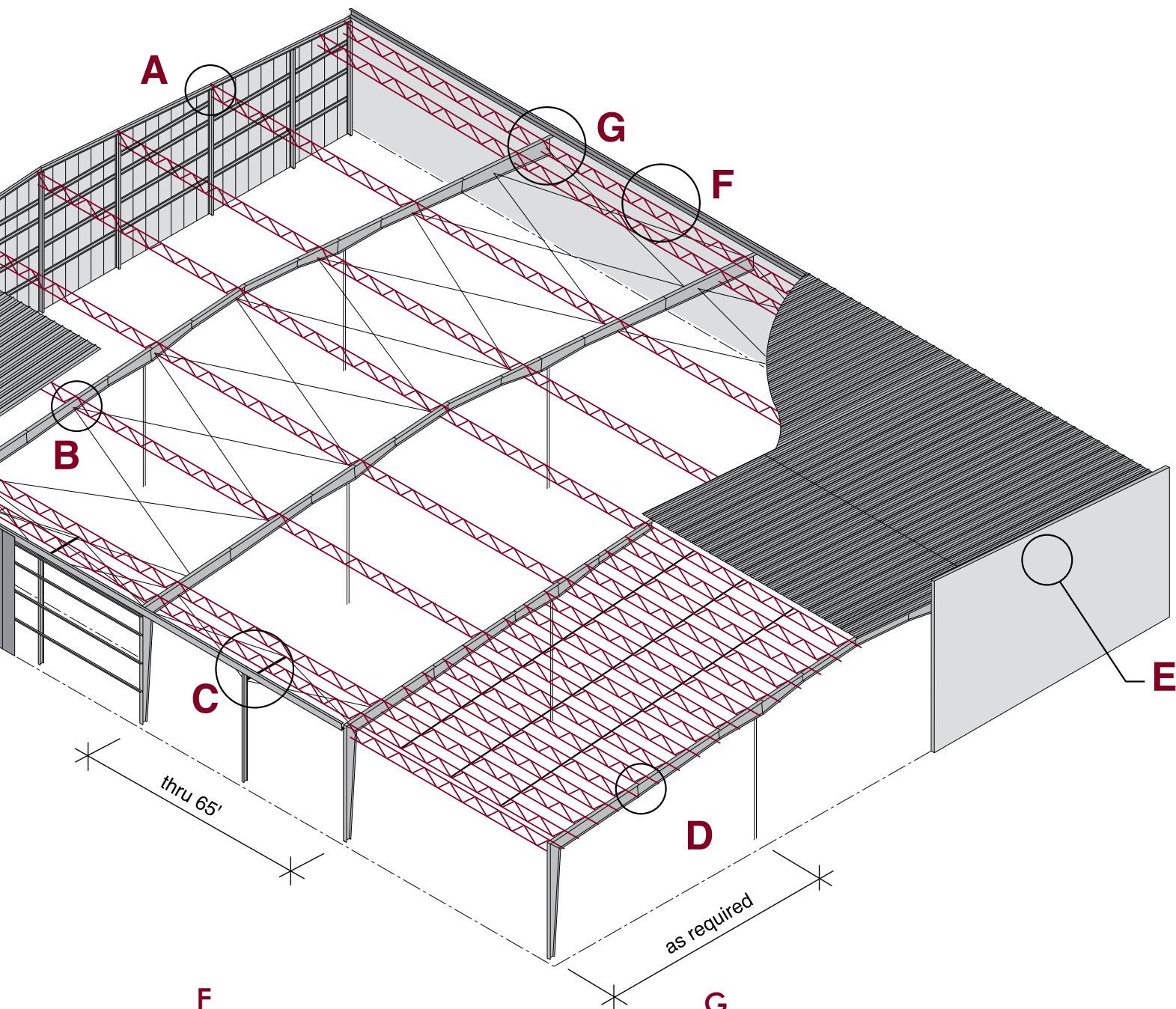

F
Long Bay® Spandrel Purlin
at Masonry Sidewall

G
Long Bay® Spandrel at
Main Frame (with Masonry Wall)

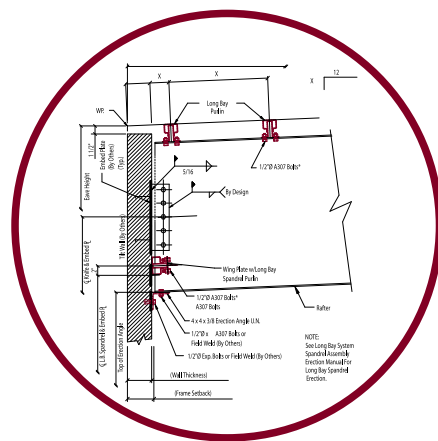
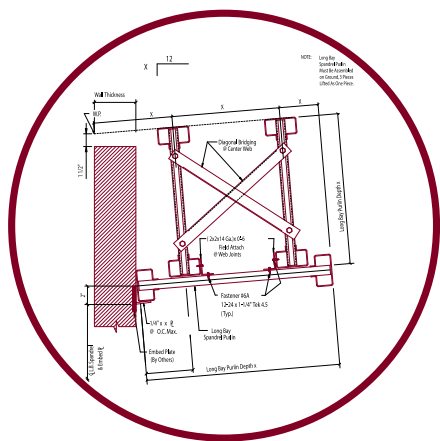



As an affiliated company of NCI Building Systems, Inc. (NYSE:NCS), Mesco Building Solutions is able to incorporate MBCI, IPS, and DBCI product lines in its offerings.

mescobldg.com/longbayframing

LOCATION:
5244 Bear Creek Ct. Irving, TX 75061

TOLL FREE:
800-556-3726

LOCAL:
214-687-9999

FAX:
214-687-9736